

ROOF MEMBER SCHEDULE	
RB1	250 UB 25
RB2	360 x 63 E-BEAM OR 150 UB 14
RB3	200 x 63 E-BEAM OR 150 UB 14
RB4	200 x 63 E-BEAM
RB5	MIN 170 x 45 E-BEAM OR 170 x 45 MGP10
RB6	240 x 63 E-BEAM
RB7	140 x 35 MGP10
RB8	2/240 x 45 MGP10. NAIL LAMINATE TO AS1684 OR 150 UB 14 OR 125 PFC
RB9	200 UB 22
VR1	MIN 170 x 45 MGP10
R1	MIN 140 x 35 MGP10 RAFTERS @ 600c/c. MAX UNSUPPORTED SPAN 3400
DR1	DENOTES DOUBLE RAFTER. NAIL LAMINATE TO AS1684.

SC1 - 50 x 50 x 3.0 SHS
 - 8PL BASEPLATE & 2M10 MEDIUM DUTY ANCHORS TO FOOTING.
 - PROVIDE 3PL SEAL & 8PL CLEAT FULLY WELDED TO TOP OF COLUMN. EXTEND COLUMN UP TO ROOF OR CEILING LEVEL & FIX TO ROOF OR CEILING MEMBER OVER VIA 2M10 BOLTS.
 - R6 RODS HIT (50) AND MISS (150) WELDED TO COLUMN. FIX STANDARD 3.15 DIA WIRE TIES TO BRICKWORK AT 4c MAX CRS. FLASH TO BUILDER'S DETAIL.

SC2 - 100 x 50 x 3.0 RHS
 - 8PL BASEPLATE & 2M10 MEDIUM DUTY ANCHORS TO FOOTING.
 - PROVIDE 3PL SEAL & 8PL CLEAT FULLY WELDED TO TOP OF COLUMN. EXTEND COLUMN UP TO ROOF OR CEILING LEVEL & FIX TO ROOF OR CEILING MEMBER OVER VIA 2M10 BOLTS.
 - R6 RODS HIT (50) AND MISS (150) WELDED TO COLUMN. FIX STANDARD 3.15 DIA WIRE TIES TO BRICKWORK AT 4c MAX CRS. FLASH TO BUILDER'S DETAIL.

SC3 - MIN 40 x 40 x 3.0 SHS
 - MANUFACTURE WINDOW FRAMES TO SUIT COLUMN.
 - FULLY WELD TO STEEL BEAM UNDER OR FULLY WELD 8PL CLEAT TO BASE OF THE COLUMN & FIX VIA 2M10 BOLTS.
 - PROVIDE 3PL SEAL & 8PL CLEAT FULLY WELDED TO TOP OF COLUMN. EXTEND TO ROOF & FIX TO RB7 VIA 2M10 BOLTS.

USE **SL62** MESH. ALL OTHER SLAB & FOOTING DETAILS AS PER PREVIOUSLY ISSUED DETAIL.

TD = TIEDOWN ROOF SUPPORTING MEMBERS IN ACCORDANCE TO THE ATTACHED SPECIFICATION. TIE DOWN REMAINDER OF THE ROOF IN ACCORDANCE WITH AS 1684.2 'RESIDENTIAL TIMBER FRAMED CONSTRUCTION' OR TO THE ATTACHED SPECIFICATION.

WIND CLASSIFICATION: N2

ROOF COVER: METAL

REV	BY	ISSUE / REVISION DESCRIPTION	JOB No	DATE	DRAWN	
0	EAM/EAM	ISSUED FOR CONSTRUCTION	J173038	16/02/17	DESIGNED	
					REVIEWED	
					DATE	
					APPROVED BY	

PROJECT No.	PROJECT
SCALE 1:100	CLIENT
SHEET 2 of 7	SIZE A3

PROVIDE TD TO RB2 ONLY. FIX RB6 TO RB2 AS NOTED IN TIMBER ROOF NOTES. ALTERNATIVELY, DO NOT FIX BEAMS TOGETHER AND PROVIDE TD TO EACH BEAM AS SHOWN.

TD IS NOT REQUIRED IF BEAM IS DIRECTLY FIXED TO THE COLUMN.

PROVIDE AN ADDITIONAL BRICK LEAF.

CONSTRUCTION JOINT. CONSTRUCT AS PER 'CJ' DETAIL.

BWB (2700 LONG)
 BWB (800 LONG) BWB (2400 LONG) BWB (800 LONG)

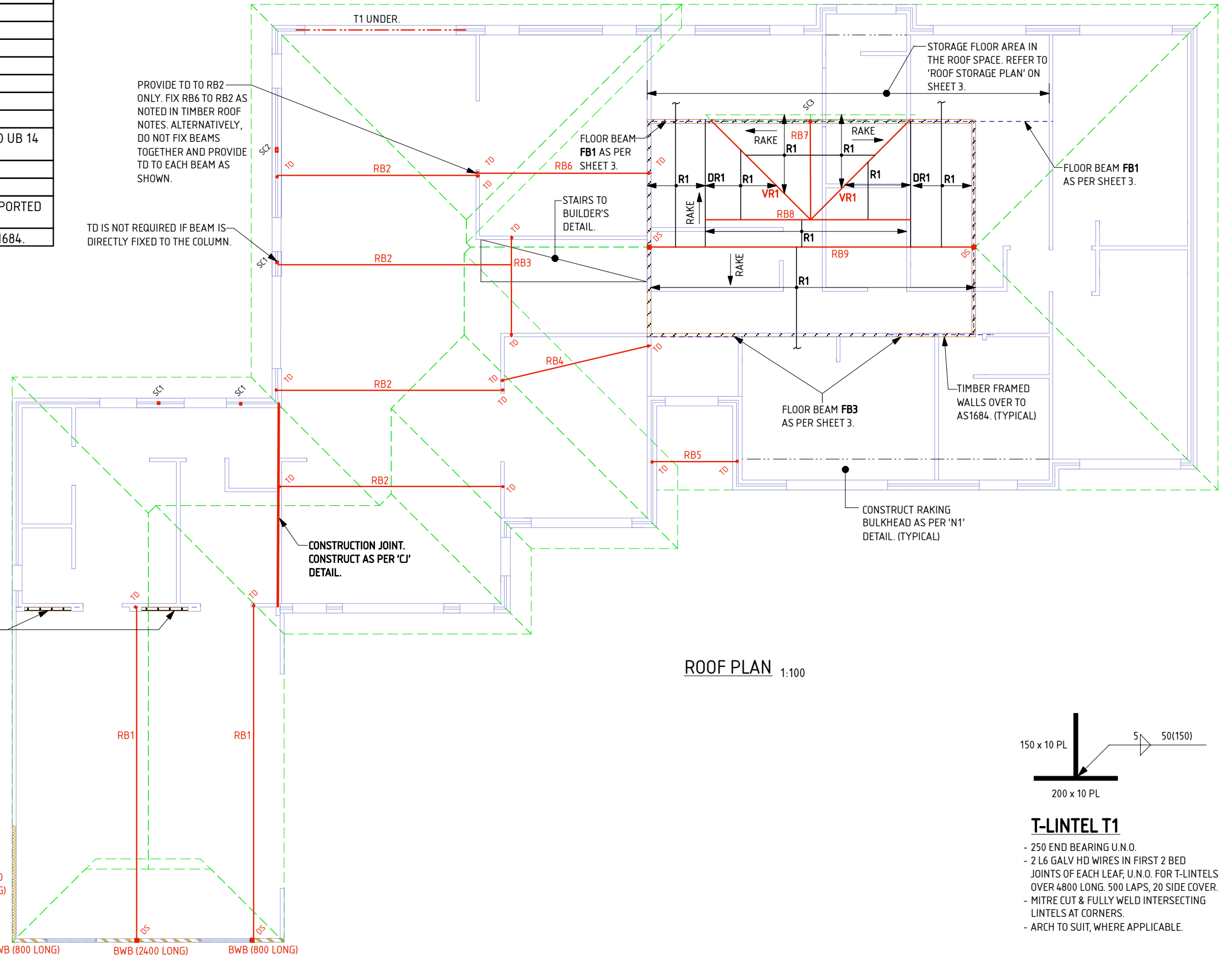

ROOF PLAN 1:100

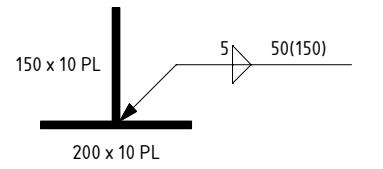

T-LINTEL T1
 - 250 END BEARING U.N.O.
 - 2 L6 GALV HD WIRES IN FIRST 2 BED JOINTS OF EACH LEAF, U.N.O. FOR T-LINTELS OVER 4800 LONG. 500 LAPS, 20 SIDE COVER.
 - MITRE CUT & FULLY WELD INTERSECTING LINTELS AT CORNERS.
 - ARCH TO SUIT, WHERE APPLICABLE.

FLOOR MEMBER SCHEDULE	
FB1	180 UB 16
FB2	150 UB 14
FB3	240 x 63 E-BEAM OR 150 UB 14
FB4	400 x 63 E-BEAM OR 180 UB 16
B1	240 x 63 E-BEAM BEARER
J1	240 x 63 E-BEAM JOIST @ 600c/c. MAX UNSUPPORTED SPAN 4000

BUILDER'S NOTE:
 TIMBER STORAGE FLOOR HAS BEEN DESIGNED TO SUPPORT A MAXIMUM IMPOSED LOAD OF 150kg/m². TIMBER STORAGE FLOOR, INCLUDING FB1 - FB3, HAVE BEEN DESIGNED TO SUPPORT STUD WALL OF MAXIMUM 3m HIGH. PROVIDE SLAB THICKENING BELOW INTERNAL WALLS SUPPORTING TIMBER STORAGE FLOOR. REFER TO NOTE 3.16 OF PREVIOUSLY ISSUED "REACTIVE SITE NOTES".

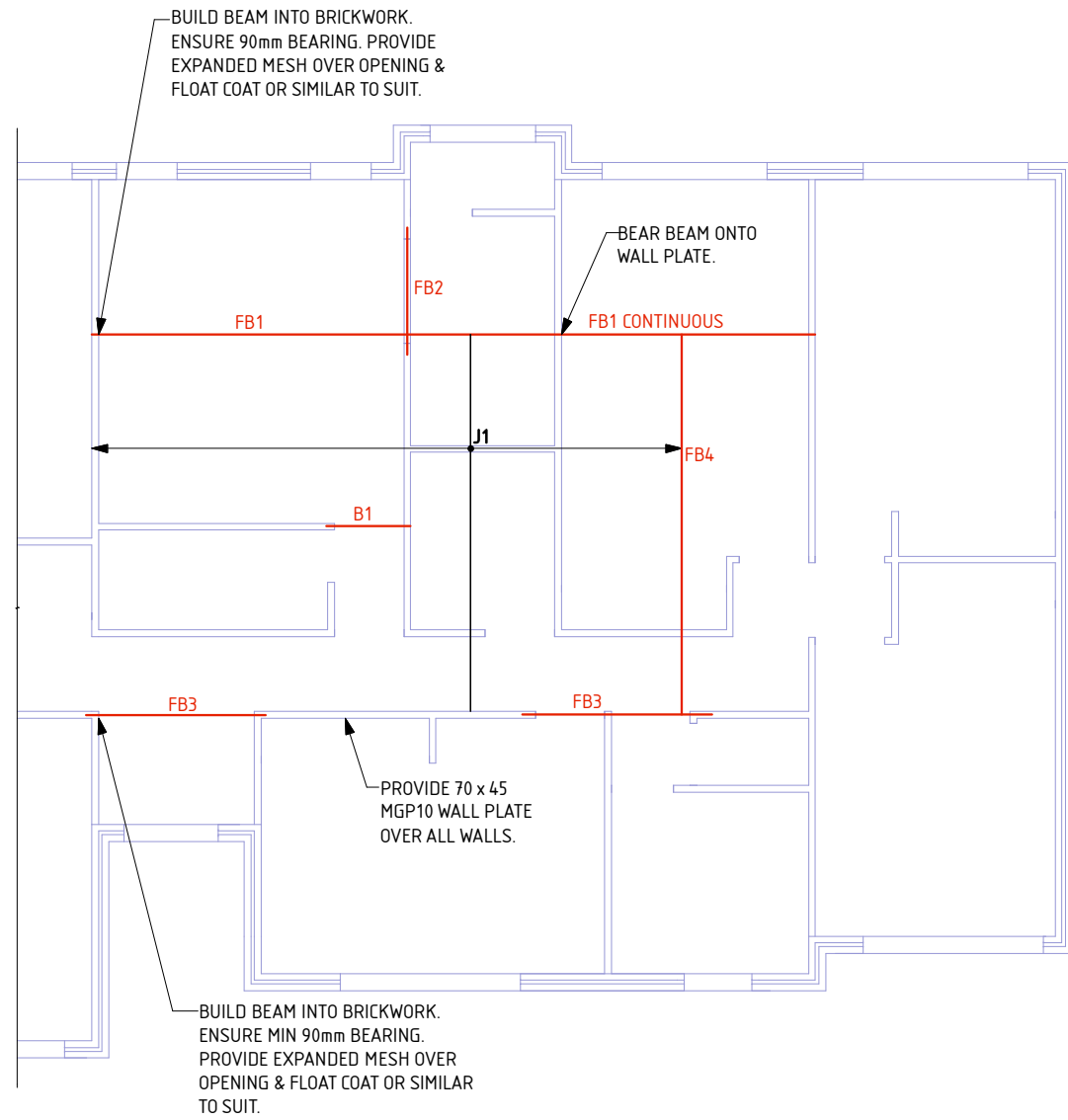

ROOF STORAGE PLAN 1:100

REV	BY	ISSUE / REVISION DESCRIPTION	JOB N°	DATE	DRAWN	
0	EAM/EAM	ISSUED FOR CONSTRUCTION			DESIGNED	
					REVIEWED	
					DATE	
					APPROVED BY	

PROJECT No.	PROJECT
SCALE 1:100	CLIENT
SHEET 3 of 7	SIZE A3